



Bahnhof

ROCK CLUB
ROTER GUGL

Leitersdorf

Technical Information Sheet

INDOOR (Club)

Version V2_2018

Index

- 1. PA 2
- 2. Processing and Amping: 2
- 3. FOH..... 2
- 4. Monitoring 2
- 5. Microphones and DI 2
- 6. Stage..... 3
- 7. Cabling 4
- 8. Backline:..... 4
- 9. Light-Console:..... 4
- 10. Lighting System:..... 4

For any question about this document please don't hesitate to contact:

Martin Jandrisics

Technical Venue Manager

Phone: (0043) 680 40 85 125

Mail: tech.rotergugl@gmail.com

1. PA

Fully hornloaded Groundstack (Active three Way) consisting of:

2x Martin Modular 115 Bass Bin /Side

1x ATC 2x12" Midhorn /Side

1x Faital Elliptical Tractrix Horn /Side

2. Processing and Amping:

1x dbx Driverack 260

1x Crest 8001

1x QSC USA 1300

1x Electrovoice LX

3. FOH

1x Behringer X32 Fullsize

4. Monitoring

Mixing via FOH (Mixbus 1 to 4)

4x Wedges Martin Stage 2x12" connected to 2x Mackie M1400

Connection to Bring-Your-Own-In-Ear-Monitoring possible

5. Microphones and DI

4x Shure SM58

3x Shure SM57

3x Samson Q-Tom

1x Samson RE20

3x Samson C02

1x AKG D112

2x BBS AR133 DI

1x Behringer DI

1x t.racks 4x DI passive



6. Stage

Stage Size:

(WxDxH) 5m x 3m x 0.3m

Drum Riser:

(WxDxH): 2.5m x 2m x 0.2m

Width:

Between the PA-Stacks: 5m

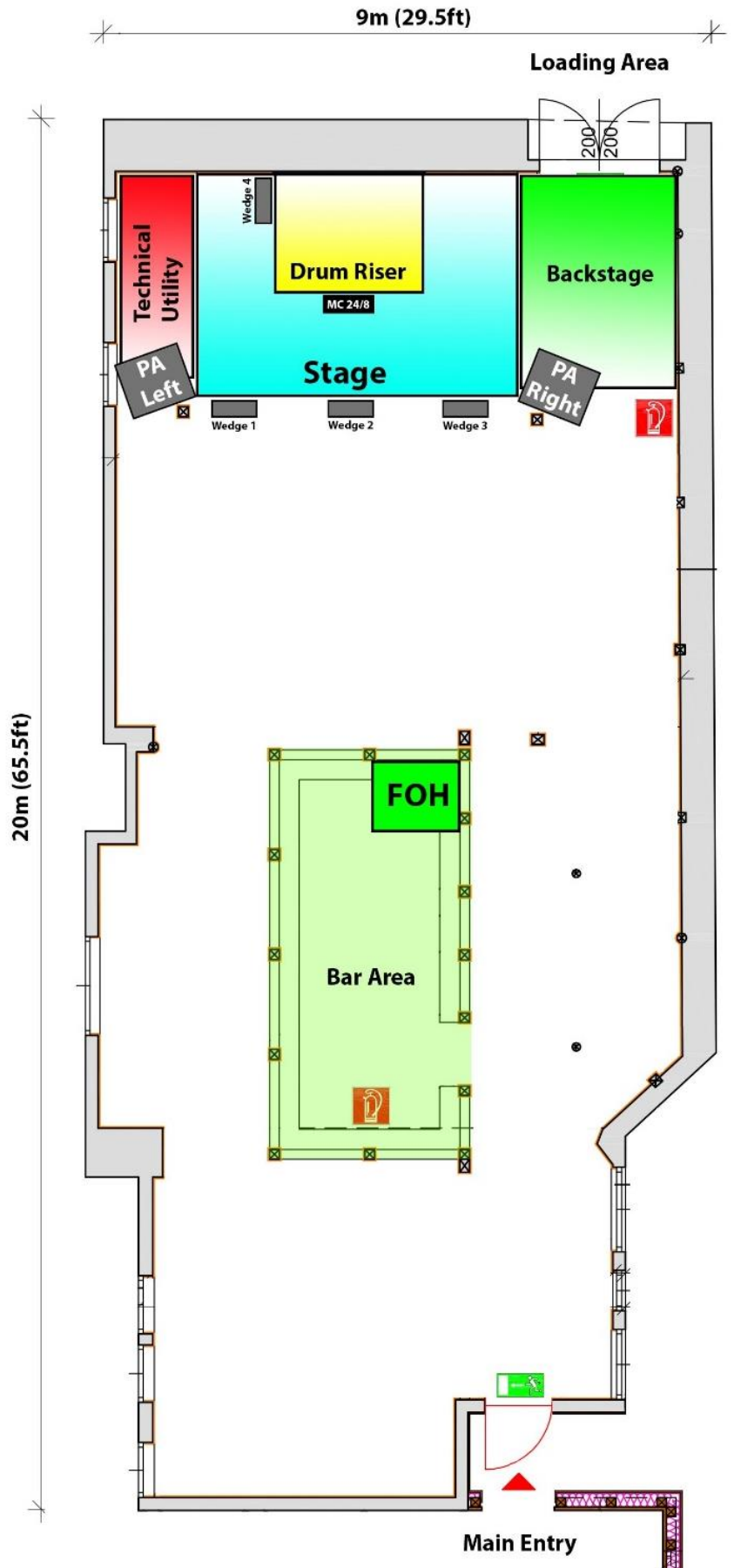

7. Cabling

1x Analog Multicore 24 Inputs / 8 Outs 30m

On Request:

1x Digital Snake Cat5 30m Cabling

1x Behringer S32 Digital Stagebox

8. Backline:

Drumset: Yamaha Stage Custom (Red)

22" Kick

14" Snare

12", 14" Rack Toms

18" Floor Tom

4 Cymbal Stands

Guitar:

1x Austrovox B100 2x12" Box (V30)

1x Marshall 1960 4x12" Box

Bass:

1x Ampeg SVT 410 Box 4x10"

Additional Equipment is in house and can be rented from the club at low cost:

1x Marshall JCM900 100Watt

1x Ashdown Toneman 300

9. Light-Console:

1x Cuelux512 on Windows 7 Server-PC

10. Lighting System:

2x Lightmaxx Led-Spot 90W Moving Head

6x Stairville LED-Par64 (Backlight)

2x Stairville LED-Par64 (Floorlight)

6x FT-046 RGBWAUV LED-Par (Frontlight)

8x Par64 500W Raylight (Sidewings)

4x Geni 200W Scan

1x Strobe 1000W